

# SEAMLESS TECHNOLOGY

ELECTRONIC SEAMLESSWEAR KNITTING MACHINE

## SM8-TOP2 SINGLE JERSEY

# SEAMLESS TECHNOLOGY

## SM8-TOP2 SINGLE JERSEY



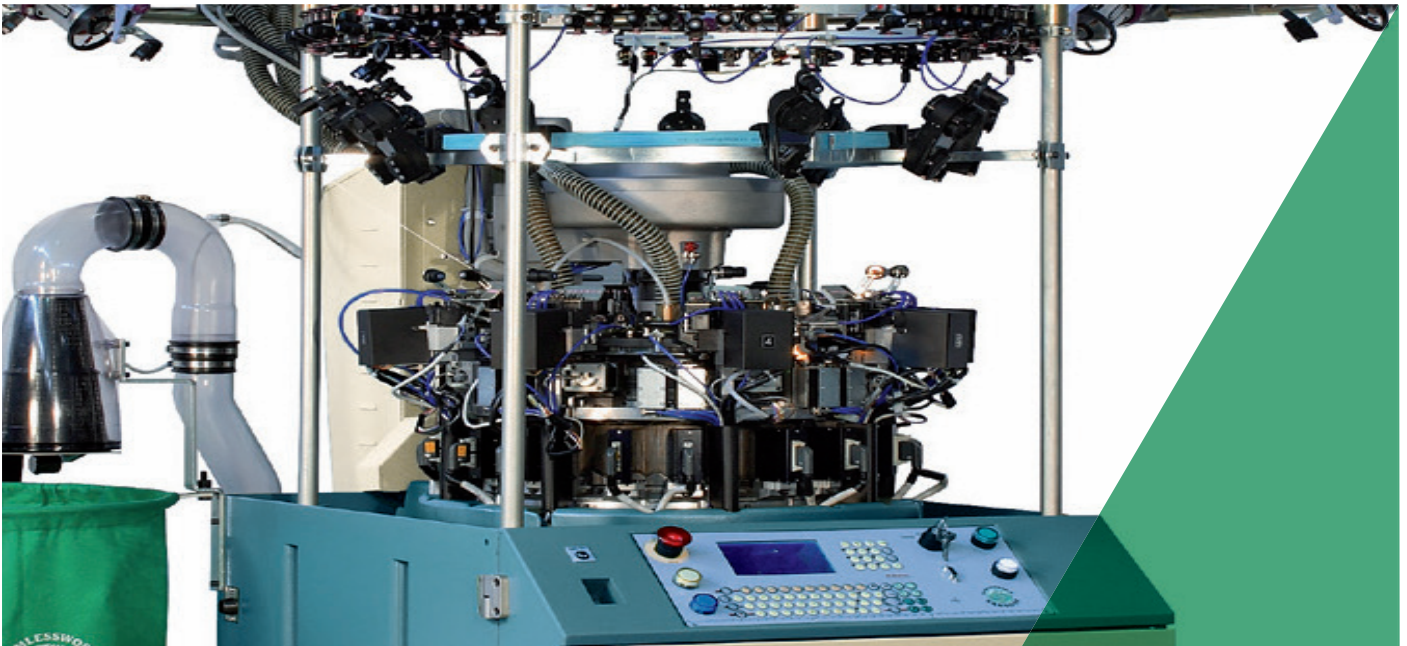

## SEAMLESS TECHNOLOGY

### SM8-TOP2 SINGLE JERSEY

---

Single jersey electronical circular machine with 8 feeds with 2 points of selection needle by needle per feed. For the production of single seamless garments for underwear, outerwear, beachwear, sportswear, sanitarywear. Terry possibility on request. System patented by SANTONI that allows the realization on 8 feeds of patterns having an high definition and sharpness of the color.

---

CERTIFICATION



Green  
Label

# SEAMLESS TECHNOLOGY

## SM8-TOP2 SINGLE JERSEY

### TECHNICAL FEATURES

#### ● DIAMETERS

12" - 13" - 14" - 15" - 16" - 17" - 18" - 19" - 20"

#### ● MACHINE GAUGE

Npi 16 - 18 - 20 - 22 - 24 - 26 - 28 - 32 - 40.

#### ● NEEDLES GAUGE

From gg 48 to gg 80.

#### ● NUMBER OF FEEDS

8 for any diameter.

#### ● MAXIMUM SPEED

Diameter 12" speed factor from 1200 (100 rpm) also for 40 Npi.  
Diameter from 13" to 20" speed factor from 1430 (13" 110 rpm).  
For mcs gauge Npi 40 speed factor from 1250 (13" 95 rpm).

#### ● TYPE OF SELECTION

N° 2 actuators with 16 levels on each feed.

#### ● STRIPPING YARNFINGERS

8 yarnfingers per feed being: (with yarnfinger 1 and 2 at 3 positions, the 3rd at 2 positions, the 4th and 5th at 4 positions and the 6th at 6 positions) plus 2 color yarnfinger at 2 positions.

#### ● TRAPPER FOR BARE AND COVERED ELASTIC YARN

One each feed plus 2nd trapper for elastic welt on 2nd and 6th feed.  
On request: 2nd trapper on 4th and 8th feed or on 1st - 3rd - 4th - 5th - 7th - 8th).

#### ● DIAL JACKS AND YARN CUTTER

From 12" to 17" up and down dial movement by pneumatic control.  
From 18" to 20" up and down dial movement driven by step motor to reposition the saw blade height.

#### ● SUCTION SYSTEM

By 2 suction fans or central system. Take down tube Ø 150 mm. Garment transfer tube Ø 100 mm. Air limiting valve with electronic incremental programming. On request: kit antitwist with the rotating tube.

#### ● STITCH CAMS

Stitch formation adjustment by step motors, independently on each feed, with possibility of loop widening, tightening and shading on the same course (Santoni patent). On board garment sizing adjust able in both cms or inches.

#### ● SINKER CUP FOR TERRY

On request: sinker caps for terry fabric (except machine gauge 16, 18, 32, 40 npi).

#### ● MAIN KNITTING POSSIBILITIES

Single or double welt carried on with jacks, in several selections, with knitted, floated or laid-in elastic yarn.  
With 8 feeds on the same course: 3 technical ways, 2 technical ways plus one color on the ground yarn, sharp pattern, laid-in possibility on all feeds.  
Optional n° 4 movable stitch cams to make 4 feeds with the following knitting possibilities: 3 technical ways plus 2 colors on the ground, 3 technical ways plus one color on the ground yarn and floated pattern.

#### ● YARN FEEDERS

1 MEMMINGER SFE for each feed; n° 10 BTR ULTRAFEEDER (2 of which used for elastic welts) plus n° 8 feeders LGL SANTONI ECOPOWER with serial connection enabling visualization on board display of yarn absorption. Optional: BTR ULTRAFEEDER, MEMMINGER EFS800 - SFE - ELAN - LGL, SANTONI ECOPOWER and/or Santoni ECOPOWER ATTIVO, DINEMA YOYO.

#### ● YARN SENSORS

Optical sensors on each feed (64 in total).

#### ● CREEL

Complete back creel.  
Option: creel with pneumatic threading or closed creel for cotton kit.

#### ● LUBRICATION

Pneumatic pump with oil recycle.

## TECHNICAL FEATURES

### ● CYLINDER ROTATION

Brushless motor and electronic handwheel for manual control.

### ● ELECTRONIC CONTROLLER

HIE (High Electronic Integration) with an integrated board for the serial checking of all exits, protected from short circuit. Available RAM memory: 6 MB.

### ● MACHINE KEYBOARD

With monochromatic display backlighted.

### ● PROGRAMMING

Software Digraph 3 Plus including: Atlas, Quasar, Photon, Galois. The programs can be transferred to the machine by FDU-2/FDU-3 reader, by cable directly from the PC or by USB key.

### ● CONSUMPTION

Absorbed power from 12" to 16": fans 4,1 kW (at 400V / 50Hz) or 5,1 kW (at 220V / 60Hz), motor 2,2 kW;  
Absorbed power from 17" to 20": fans 4,4 kW (at 400V / 50Hz) or 5,6 kW (at 220V / 60Hz), motor 2,2 kW.  
Compressed air: 50 lt/min at 6 bar.

### ● WEIGHT

Approx. Kg 620 / 770.

### ● PRODUCTION

SEAMLESSWEAR, UNDERWEAR, OUTERWEAR, SWIMWEAR, SPORTSWEAR, SANITARY GARMENTS (possibility to use a wide range of yarns).

### ● NORMATIVE

The machine meets the CE normative and is UL compatible.

## TECHNICAL DRAWING AND SIZE

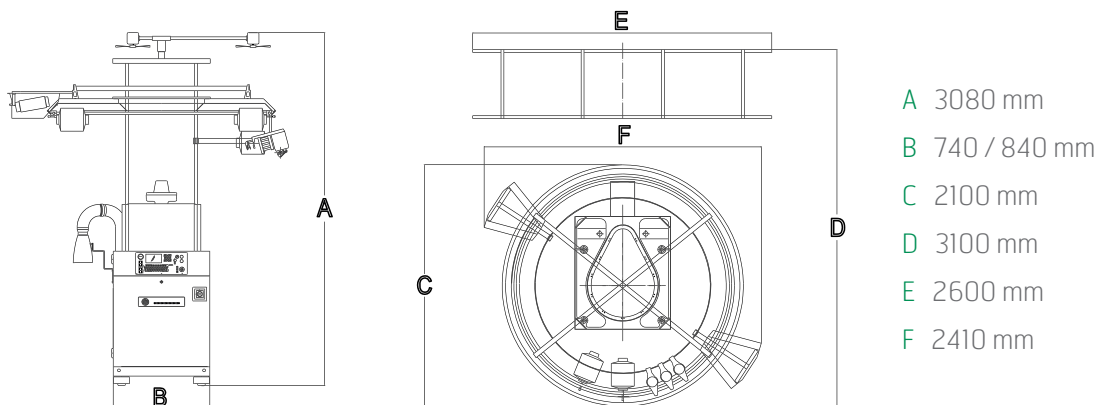

### DISCLAIMER:

Technical data given in this brochure are for information only. Santoni S.p.A. reserves the right to modify the machine features without forewarning and without the obligation to apply any modification to the machines already installed. Pictures are exemplifying and have not to be regarded as a reference.



**SANTONI SPA**

Via Carlo Fenzi, 14 - 25135 Brescia - Italy  
Tel. +39 030 376711 Fax +39 030 3366478  
P.IVA e CF: IT 00273280172  
info@santoni.com - www.santoni.com